

Note on English translation / Hinweise zur englischen Fassung

This is a translation of the technical data sheet valid in Germany.

All stated details and properties are in compliance with the regulations of the German standards and building regulations. They are only applicable for the specified products, system components, application rules, and construction details in connection with the specifications of the respective certificates and approvals.

Knauf Integral KG denies any liability for applications outside of Germany as this requires changes acc. to the respective national standards and building regulations.



GIFAtec

K436e.de

Technical Sheet

01/2024

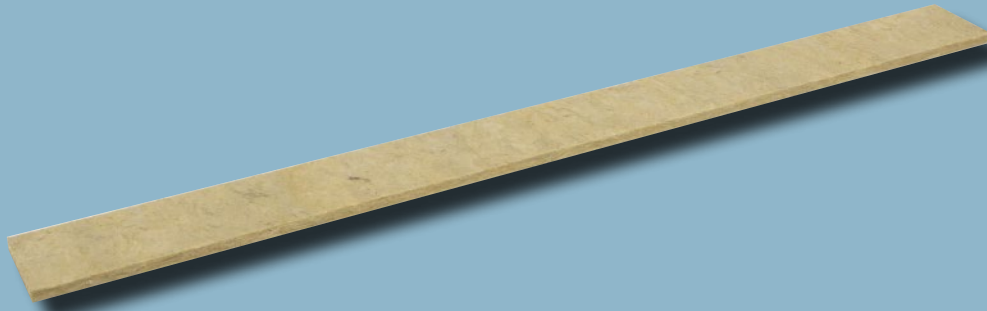

GIFAfloor edge insulation strip MW

For flooring solutions with and without fire protection

Product description

GIFAfloor edge insulation strip MW is a stable edge strip made of non-combustible rock wool.

Storage

Store in a dry place.

Properties and added value

- Very good sound insulation
- Building material class A1
- Stable
- Quick and easy installation
- Resistant to deformation and ageing

Application area

GIFAfloor edge insulation strip MW is used for hollow floor and raised floor constructions with fire protection requirements (e.g. GIFAfloor FHB or GIFAfloor DB green), retrofit solutions for joist ceilings (e.g. GIFAfloor Presto), as well as prefabricated screeds with or without fire protection requirements (e.g. GIFAfloor HUGO L).

GIFAfloor edge insulation strip MW is fixed to all rising building components to avoid sound bridges and contacts that can lead to impairment of the insulation properties.

Verweise auf weitere Dokumente

- F16.de Knauf GIFAfloor HUGO L
- F18.de Knauf GIFAfloor hollow floor
- F19.de Knauf GIFAfloor self supporting systems
- F185.de Knauf GIFAfloor DB green raised access floor

Examples application areas

Illustration of the GIFAfloor edge insulation strip MW, used in:

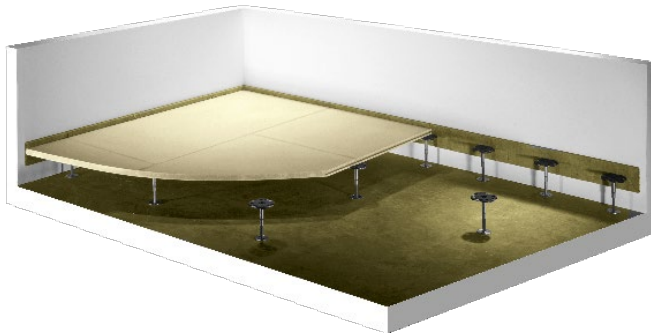

- a Knauf GIFAfloor FHB hollow floor system.

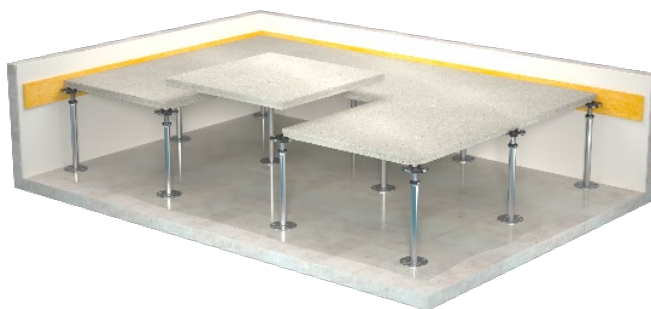

- a raised floor system Knauf GIFAfloor DB green.



- a joist ceiling with Knauf GIFAfloor Presto.



- a prefabricated screed Knauf GIFAfloor HUGO L.

Implementation

Processing



Mark the finished height of the screed on all rising components and fix GIFAfloor edge insulation strip MW with the top edge at least 5 mm higher than the finished height.

GIFAfloor edge insulation strip MW must protrude above the top edge of the screed, at least up to the surface of the top covering.

Possible fixing of the GIFAfloor edge insulation strip MW by stapling above or below the screed cross-section including covering or by gluing, e.g. with Knauf Uniflott.

Ensure that the GIFAfloor edge insulation strip MW is laid without gaps.

Push the insulation onto the GIFAfloor edge insulation strip MW. If there are several layers of insulation, lay the edge insulation strip MW with the top insulation layer.

In case of levelling layers (e.g. Knauf EPO-Leicht), pull the insulation layer cover (e.g. Knauf Schrenzlage) up vertically at the edge over GIFAfloor edge insulation strip MW and secure it against folding over so that no moisture or mortar can penetrate into the edge insulation strip MW or into gaps.

When installing with underfloor heating, e.g. with insulation board coated on top (e.g. Uponor Klett Panel Silent), protect the mineral wool edge insulation strip with Knauf Schrenzlage.

These steps are not necessary when laying prefabricated screed.

Then lay the floor system (e.g. Hugo L).

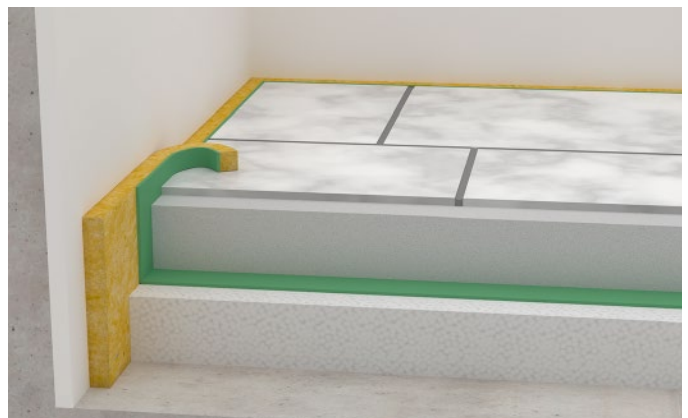

Only cut off the protruding part of the GIFAfloor edge insulation strip MW once the top layer has been laid (according to DIN 18560-2).

Technical data

Description	GIFAfloor edge insulation strip MW	Unit	Standard
Building material class	A1	class	–
Raw density	≥ 90	kg/m ³	–
Melting point	≥ 1000	°C	DIN 4102-17

Product range

Description	Height mm	Length mm	Thickness mm	Packaging unit	Article number	EAN
GIFAfloor edge insulation strip MW	100	1200	12	100 pieces/box	109147	4003982202628



Sicherheitsdatenblatt beachten!
Sicherheitsdatenblätter siehe
pd.knauf.de



Mit der Tablet App Knauf Infothek stehen jetzt alle Informationen und Dokumente der Knauf Gips KG jederzeit und an jedem Ort immer aktuell, übersichtlich und bequem zur Verfügung.
knauf.de/infothek

Knauf Direct

Technical Advisory Service:

▶ knauf-direkt@knauf.com

▶ www.knauf-integral.de

Knauf Integral KG Am Bahnhof 16, 74589 Satteldorf, Germany

All technical changes reserved. Only the current printed instructions are valid. The stated information represents current state-of-the-art Knauf technology. The entire state of approved engineering rules, appropriate standards, guidelines, and rules of craftsmanship are not included herewith. These and all application instructions have to be adhered to separately by the installer. Our warranty is expressly limited to our products in flawless condition. All application quantities and delivery amounts are based on empirical data that are not easily transferable to other deviating areas.

All rights reserved. All amendments, reprints and photocopies, including those of excerpts, require our expressed permission.