

KNAUF DESIGNLINE FIX

Installation Instructions Horizontal



1 Prepare the substrate, create even surfaces. Optional installation on metal profiles possible.



2 Install the KDLF Start rail horizontal. Spacing between the screws < 125 mm, in dependence on the substrate.

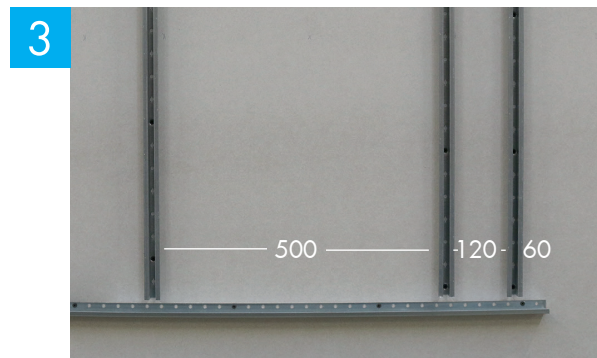

3 Attach the KDLF 18 mm rails vertically, positioning them directly on the start rail. Install two KDLF 18 mm rails at each end of the wall.



4 Position the KDLF twist clip at 45° to the KDLF 18 mm rail and twist it in.

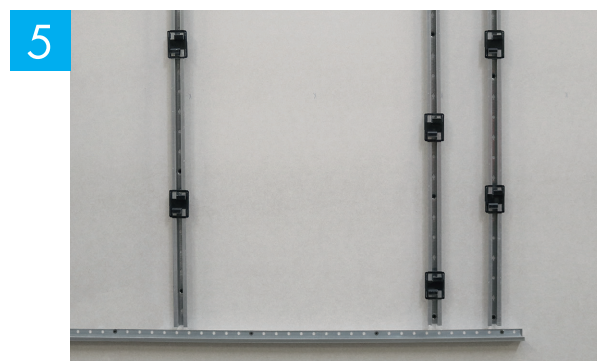

5 Install the first row of KDLF twist clips on every second KDLF 18 mm rail. Offset to one another.



6 Insert the first DESIGNLINE onto the KDLF start rail.



Force lock the DESIGNLINE using the KDLF twist clip pushed down into place.



Repeat 5-7, and for wall heights > 3m install an additional KDLF start rail.



Terminate to ceiling with KDLF end twist clip Minimum spacing to ceiling connection 10 mm.

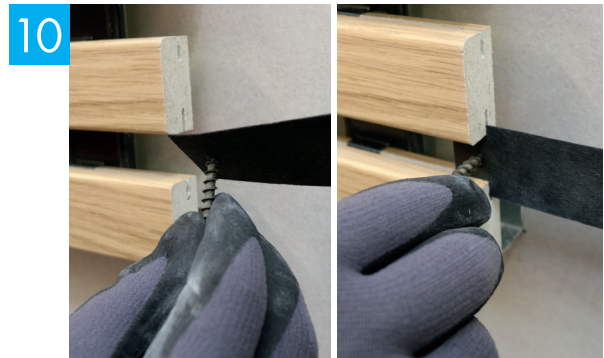

Install KDLF dampers. Tip: A screw inserted into the damper can be used to slide the damper into the grooves.



View of lateral end.



View of finished horizontal installation.

Note:

For information on installation for acoustic cavities and substrates made of metal studs, see the brochure **Tro172.de** DESIGNBOARD FIX