

KNAUF DESIGNLINE FIX

Installation Instructions Vertical



1 Prepare the substrate, create even surfaces.
Optional installation on metal profiles possible.



2 Install the KDLF Start rail V horizontal. Spacing between the screws < 125 mm, in dependence on the substrate.

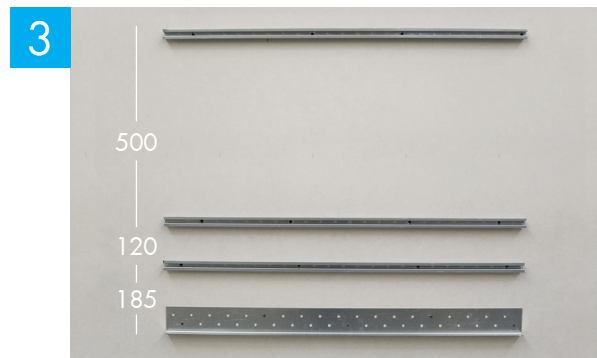

3 Attach the KDLF 18 mm rails horizontally. Install two KDLF 18 mm rails above the start rail V and at the ceiling end.

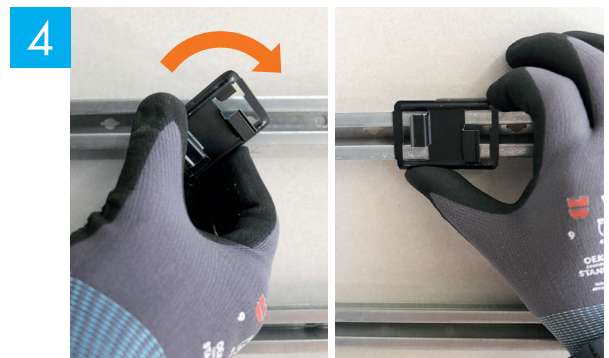

4 Position the KDLF twist clip at 45° to the KDLF 18 mm rail and twist it in.

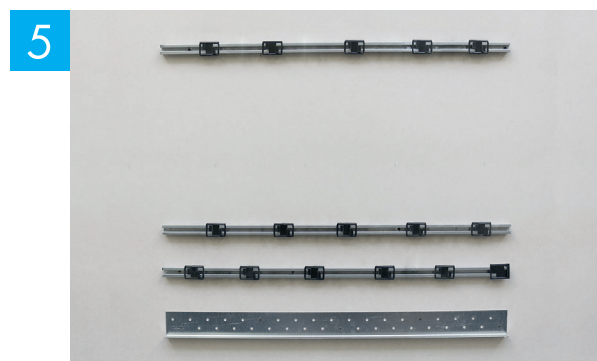

5 Install the first row of KDLF twist clips on every second KDLF 18 mm rail. Offset to one another.



6 Place the first DESIGNLINE onto the KDLF start rail.



Force lock the DESIGNLINE using the KDLF twist clip pushed into place.

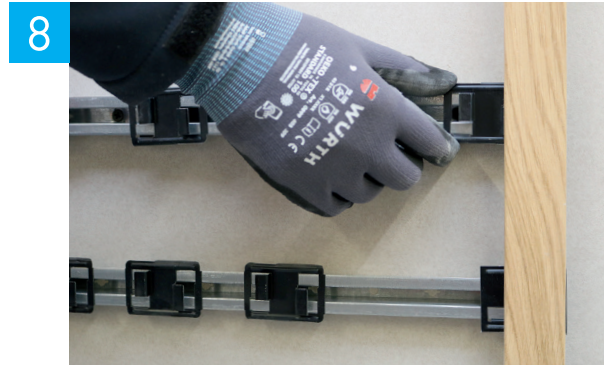

Repeat 5-7 and for wall heights > 3 m install a new KDLF start rail V.

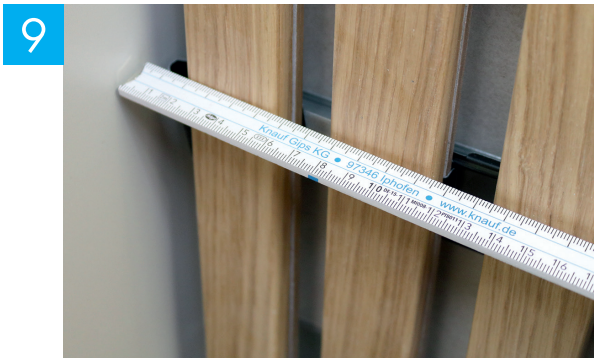

Terminate to the side wall with KDLF twist clip by at least 10 mm.



Install KDLF dampers. Tip: A yardstick is suitable for moving the damper in the grooves.



View of finished vertical installation.

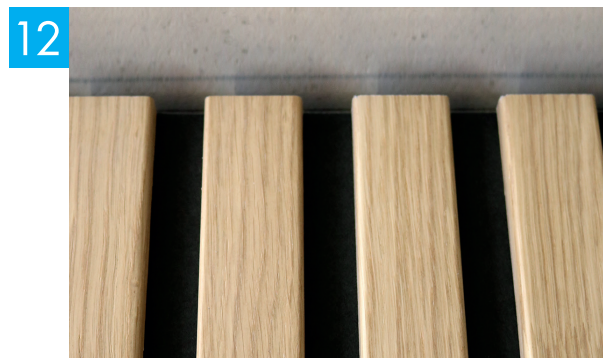

Ceiling connection view.

Note:

For information on installation for acoustic cavities and substrates made of metal studs, see the brochure **Tro172.de** DESIGNBOARD FIX