

DESIGNBOARD PROTECT

IMPACT PROTECTION SYSTEM



A SYSTEMATIC APPROACH TO MAINTAINING VALUE

The DESIGNBOARD PROTECT SYSTEM impact protection system is a creative solution that optimally combines the latest technology with aesthetic appeal.

Our PROTECT SYSTEM is used for retaining the value of the room and provides long-term protection for the appearance of all buildings with a significant footfall – especially for clinics, care homes, schools and public facilities.

The DESIGNBOARD PROTECT SYSTEM offers all convincing advantages such as fire protection, design, insulation and sound absorption as a comprehensive system.

› This is our claim:
Protection at the highest
aesthetic level

Every single component is an elementary part of the impact protection system. Consequently, we exclusively select outstanding components to guarantee maximum protection. We offer a protection system that stands for safety, resilience and design. The basis for our promise and the foundation of the entire DESIGNBOARD PROTECT SYSTEM is the Designboard 230 Laminate; this has been tested according to European standard EN 13501-1 A2-s1,d0 and classified as “non-flammable”.

A range of different decoration variants ensures that the special features and individual character of each room are retained in spite of the impact protection – the DESIGNBOARD PROTECT SYSTEM is a creative safety measure. DESIGNER DECORATIONS are available from the CREATIVE line.



TYPICAL FOR KNAUF: A COMPLETE SYSTEM THAT IS CERTIFIED

Our unique, tested design carrier is extended and supplemented by different connection and corner profiles. We use the profiles in the PROTECTRAIL range here: A scheme that is based on stainless steel or anodised aluminium impact protection rails, and achieves an outstanding level of harmonisation with the DESIGNBOARD 230 LAMINATE.

The DESIGNBOARD PROTECT SYSTEM provides comprehensive impact protection that fits flush with the wall and is practically invisible; its resilience is guaranteed by a special attachment using bonding technology or a mechanical variant.

The unmistakable Königsfuge joint from KNAUF DESIGN not only provides an appearance without joints, but also a safe connection without gaps!



The KNAUF SYSTEM

1. Existing wall
2. KNAUF DUO-KLEBER adhesive
3. DESIGNBOARD PROTECT

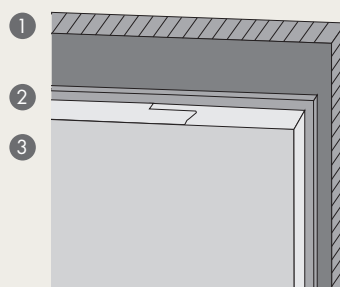

One system, many possibilities

- Fire protection (non-flammable), universally applicable, even in escape routes
- Thanks to the zero joint, can be mounted without any visible joint by means of the Königsfuge joint
- Certified and approved bonding technology allowing for extremely fast installation on site
- Robust surface that meets the most exacting requirements (resistant to chemicals and cleaning agents, resistant to scratches)
- We use a sustainable, certified gypsum fibreboard which is a non-polluting product
- The panels can be sawn, drilled, cut and bonded on site without difficulty
- The innovative PROTECT RAILS can be glued or screwed onto the non-edged cut panels (no need for cutting additional slots on site)



Appearance without joints

The patented Königsfuge joint from KNAUF DESIGN ensures an appearance without joints – a safe connection without gaps!

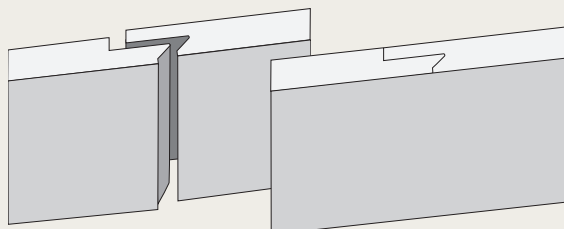

PROTECT RAIL

Profile variants in stainless steel or aluminium



Profile: P1 mitre profile 45°
[15 x 15 / 22 x 22]

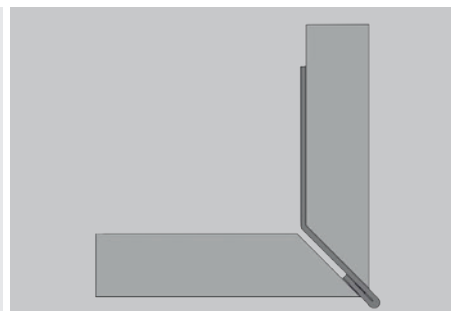

Profile: P2 star profile
[15 x 15 / 22 x 22]

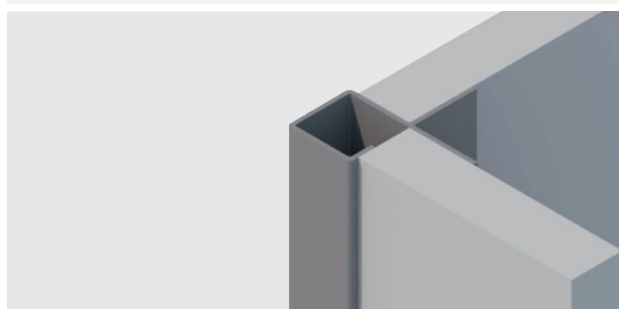

Profile: P3 square profile
[15 x 15 / 22 x 22]

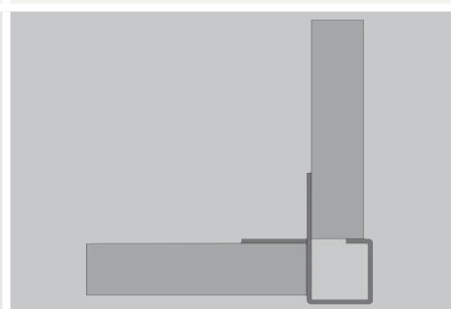

Profile: P4 connection profile
[15 x 15 / 22 x 22]

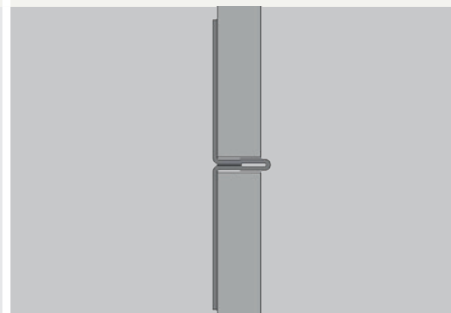

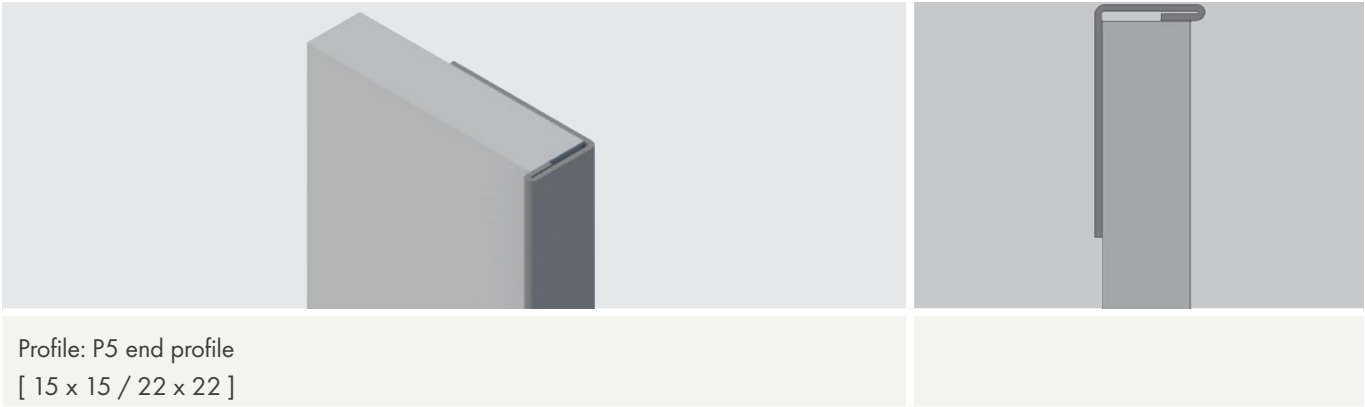

DECO- RATIONS

Plain colours

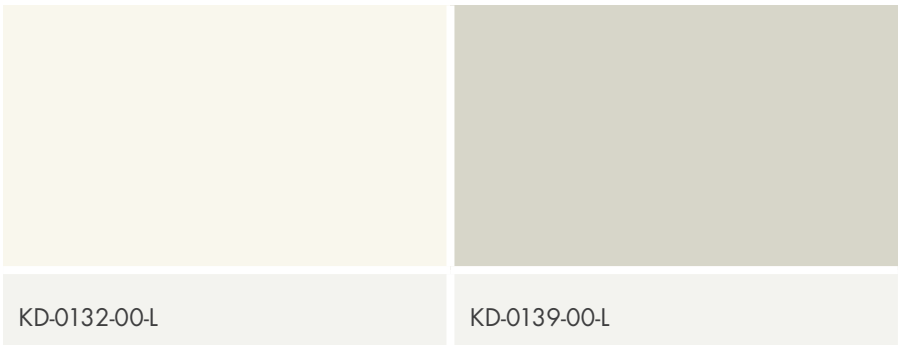

SURFACES

Structures



DESIGNER DECOR- ATIONS

Additional decorations in the fire category (non-flammable) with the same surface quality are available. Examples can be seen in the CREATIVE section of the FIRELINE brochure.



KNAUF DESIGN

KNAUF riessler GmbH & Co. KG

Süßwiesenstraße 10

74549 Wolpertshausen

Telefon: +49 7904 944681-0

Telefax: +49 7904 944681-10

info@knauf-design.com

www.knauf-design.com

Subject to technical modifications. The latest edition applies in each case. Our warranty only covers correct composition of our material. The design, structure engineering and physical properties of Knauf systems can only be achieved if exclusively Knauf system components or products expressly recommended by Knauf are used. Information about consumption, quantities and versions are based on experience, and are not applicable directly to other situations if the conditions are different. The information contained is based on our current state of the art. However, it cannot contain the complete status of generally recognised rules of building technology, relevant standards, guidelines and trade rules. These must be complied with by the persons carrying out the work, along with the processing requirements. All rights reserved.

No modifications, reprinting and reproduction either photomechanically or by electronic means, in whole or in part, without the express approval from KNAUF riessler GmbH & Co. KG. Süßwiesenstraße 10, 74549 Wolpertshausen. Our general terms and conditions of business, delivery and payment (GT&Cs) apply.

**KNAUF riessler
GmbH & Co.KG**
Süßwiesenstraße 10
74549 Wolpertshausen

Knauf AMF
Ceiling Systems

Knauf AQUAPANEL®
AQUAPANEL® Cement Board
TecTem®, Insulation Bulk Levellers

Knauf Bauprodukte
Professional DIY Solutions

Knauf Design
Surface Competence

Knauf Gips
Drywall Systems
Plaster and Facade Systems
Floor Systems

Knauf Insulation
Insulation systems for renovation
and new construction

Knauf Integral
Gypsum Fibre Technology
for floors, walls and covers

Knauf PFT
Machine Technology and
Plant Engineering

Marbos
Mortar Systems for Stone
Pavements in
Civil Engineering

Sakret Bausysteme
Dry Mortars for New
Projects and Renovations